

CFX VACUUM MOTOR REPLACEMENT

Tools Required: 5/16" Socket or Nut Driver, 7/16" Wrench, Phillips Screwdriver, Needle Nose Pliers, Zip Ties

Vacuum Motor Removal

****NOTE: MACHINE MUST BE UNPLUGGED DURING MAINTENANCE****

- 1) Remove the two cover plate screws and unplug the cover plate from the wire harness.



- 2) Remove the exhaust manifold screw and remove the exhaust manifold.



- 3) Unlatch the CFX top housing from the bottom housing and turn it upside down, placing the top inside the bottom housing.



- 4) Use a 5/16" wrench or nut driver to remove the eight deck plate screws

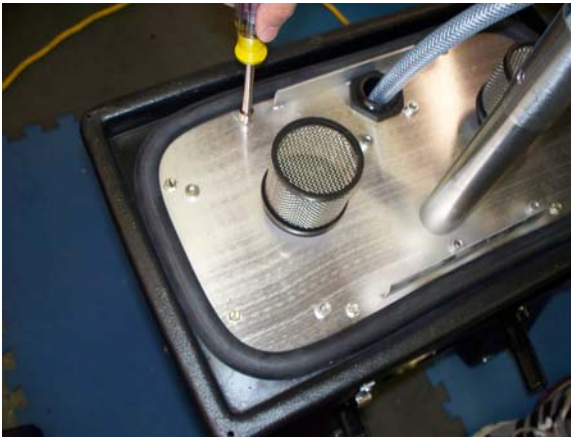

- 5) Holding the deck plate firmly to the top housing, turn the top housing back to right side up and place it back on top of the bottom housing.



6) Lift up on the top housing, removing it from the deck plate.



7) Use a pair of needle nose pliers to unplug the wire terminals from either side of the vacuum motor that will be replaced.



8) Use a Crescent wrench to remove the hose fitting from the bottom of the pump.

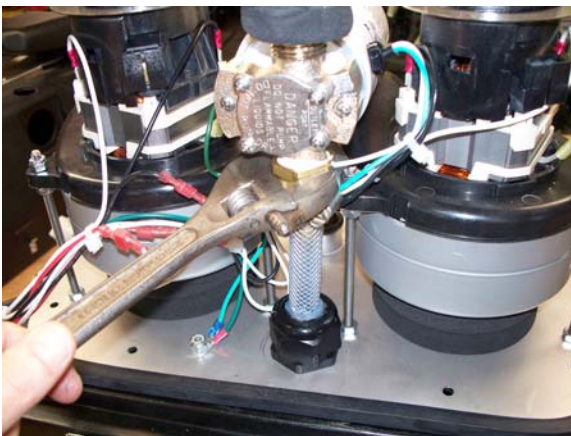

- 9) Use a 7/16" wrench to remove the three pump mounting nuts and remove the pump module.

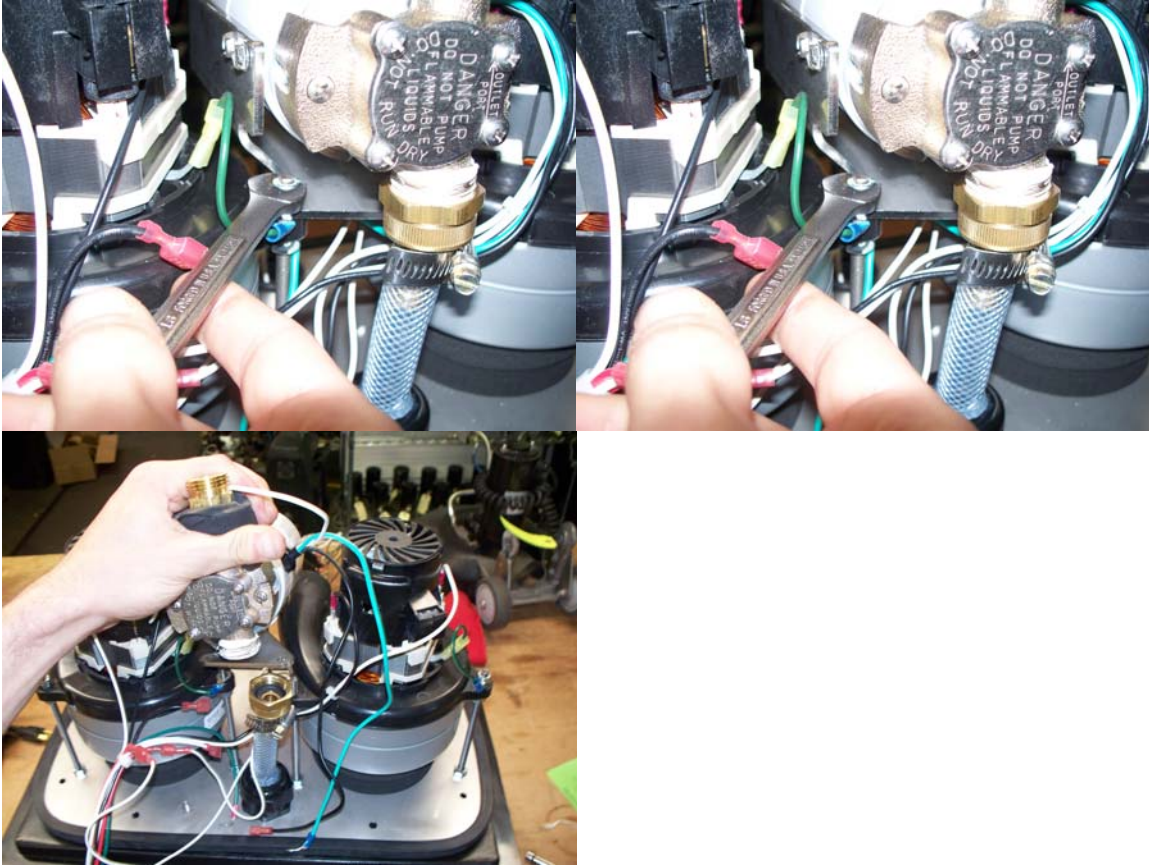

- 10) Use a 7/16" wrench to remove the two remaining vacuum mounting nuts and remove the vacuum motor.

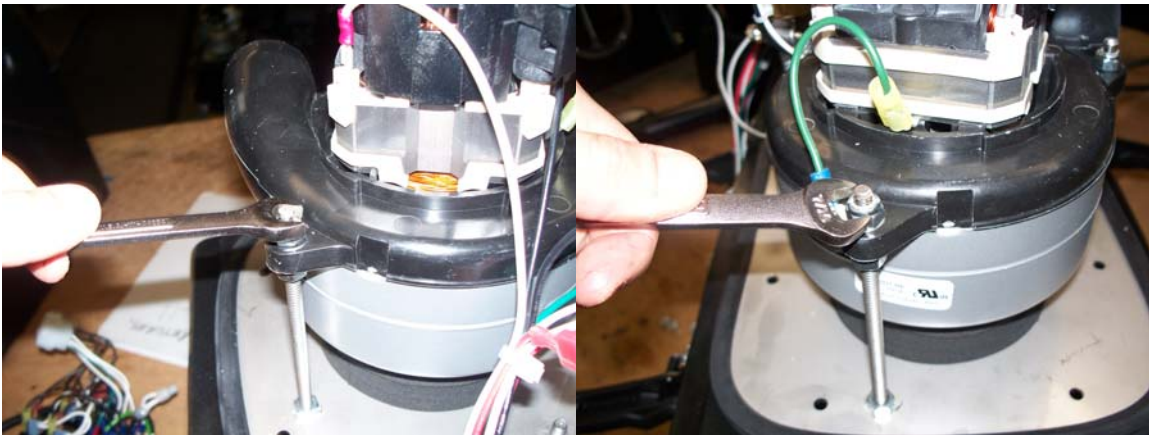

NOTE: For reassembly follow instructions in reverse order. Be sure to zip tie the wire harness neatly into place.

****IMPORTANT: MAKE SURE TO TIGHTEN THE HOSE FITTING TO THE PUMP WITH A WRENCH TO PREVENT AIR LEAKS****